

CERTIFIED RECORD OF LAND CORNER MONUMENTATION.

History of original corner establishment:

Established in 1884 by William R. Gradon under contract number 497, dated March 7, 1884. Surveyor General's records state:

Set a basalt stone 10x10x7 ins 6 ins in the ground for 1/4 sec cor marked 1/4 on north face from which

a fir 20 ins diam bears N. 50° W. 10 lks dist marked 1/4S BT
a pine 18 ins diam bears S 10°W. 15 lks dist. marked 1/4S BT

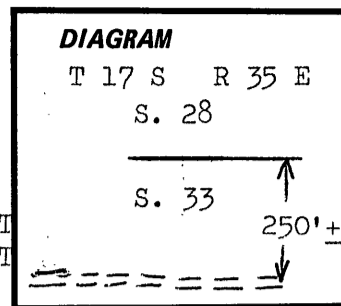

Description of corner evidence found:

I found a stone 18x10x7 marked 1/4 on north face in a mound of stone with a 3" x 4' post alongside. Rock has been painted red. A 20" decomposed snag lies approx. 3 feet south with 1/4 S BT scribed on the southeast side. A fir stump bears N. 10° W. 7.5 ft distant, painted red, but no scribing visible.

Description of monument and accessories I established to perpetuate the original location of this corner:

At the location of the marked rock I set a standard F.S. aluminum monument consisting of a 3" disk mounted on a 2 1/2 x 30" pipe with a 4 x 4 1/2" footplate buried upright 19" with 11" protruding above the ground. The marked rock is buried alongside. The disk on the monument is marked as shown.

An 8" PP bears N. 35° W. a distance of 70.7 ft, scribed 1/4 S 28 BT
a 23" DF bears S. 21° E. a distance of 19.0 ft, scribed 1/4 S 33 BT

Both BT's are banded with red paint, carry BT and Attention signs and have brass disks stamped PLS 1287 nailed at the base of the BT blazes.

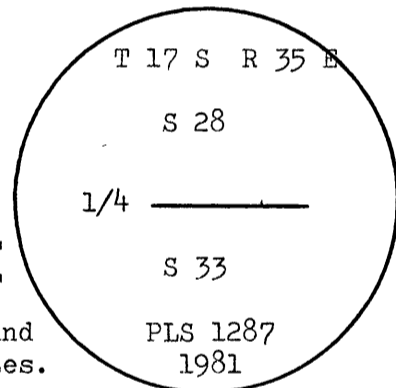

Work done: Nov. 13, 1982

Witnesses: P. Zabala
H. Palmer

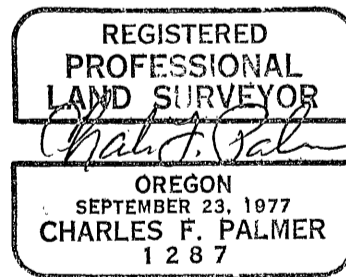

Office of..... Surveyor County of..... Grant

State of..... Oregon I hereby certify that the within instrument was filed in this office

for record on the..... 23 day of..... Nov, 19..... 82

Robert D. Baggett by.....
(COUNTY OFFICIAL) (DEPUTY)